

# Tapwell

## TA242 Accessory

---

TA242 Chrome

---

### Article Number

TA242 Chrome - 9419071  
TA242 Matte Black - 9420505  
TA242 Polished Brass - 9419072  
TA242 Copper - 9420090  
TA242 Bronze - 9425851  
TA242 Black Chrome - 9419060  
TA242 Honey Gold - 9419061  
TA242 Brushed Black Chrome - 9422838  
TA242 Brushed Nickel - 9421174  
TA242 Ascot Grey - 9422839

---

Towel hook medium, 2 per pack.



# Tapwell

---

## **Cleaning**

Wipe the surface with a soft cloth and lukewarm water and possibly with soap solution. Avoid alkaline, acid-liming or abrasive cleaners.

Brass is a material that over time gets a beautiful patina but can be polished with brass polish. Copper also gets patina but should not be polished. The other shiny surfaces retain their luster.

## **Decalcification**

Aerators and shower handles should be regularly decalcified by placing them in a vinegar bath for a couple of hours. Should limescale stains occur, use eucalyptus oil and a soft cloth.

## **Lubrication**

Lubricate only with silicone grease.

## **Maintenance**

Visit our [YouTube channel](#) → where there are instructional videos for changing the ceramic cartridge, changing aerators and more.

---

## **Dimensions/Weight**

**Product - Width:** 22 mm

**Product - Depth:** 50 mm

**Product - Height:** 36 mm

# Tapwell

Drawing - PDF

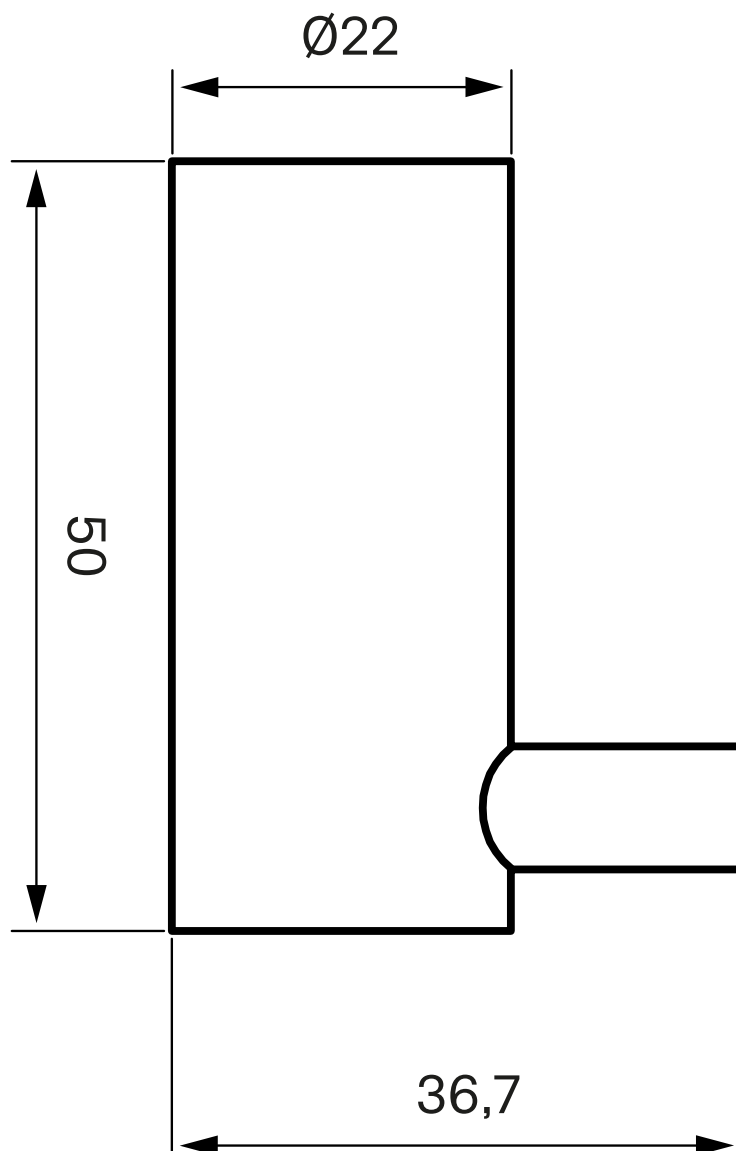

# Tapwell

## Exploded View

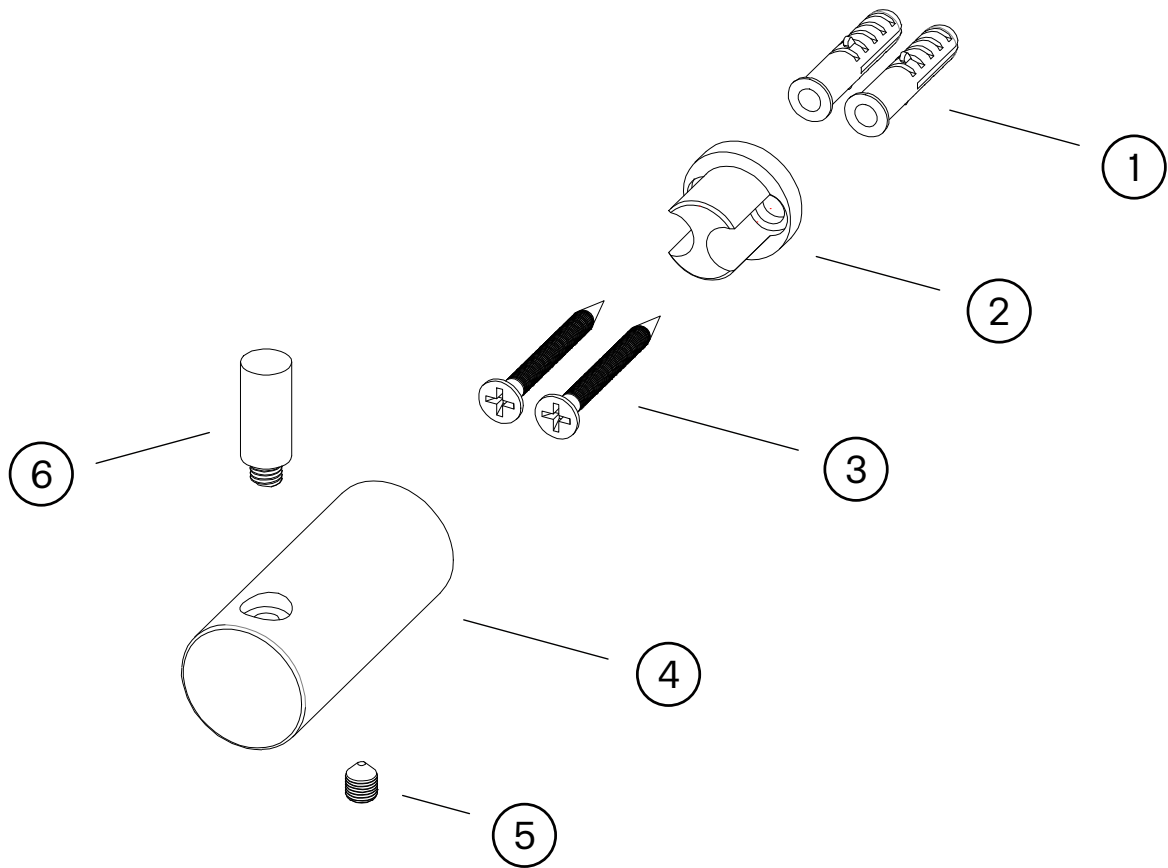

1. Screw plug  $\text{Ø}6 \times 30 \text{ mm}$
2. Screw attachment  $\text{Ø}19 \times 16,5 \text{ mm}$
3. Screw  $\text{M}4 \times 35 \text{ mm}$
4. Hook  $\text{Ø}15 \times 30 \text{ mm}$
5. Allan screw  $\text{M}5 \times 6 \text{ mm}$
6. Knob  $\text{Ø}8 \times 21,4 \text{ mm}$